

ACTUAL SIZE

CONNECTOR MATES WITH DYTRAN CABLE 6811AXX  $\triangle 3$

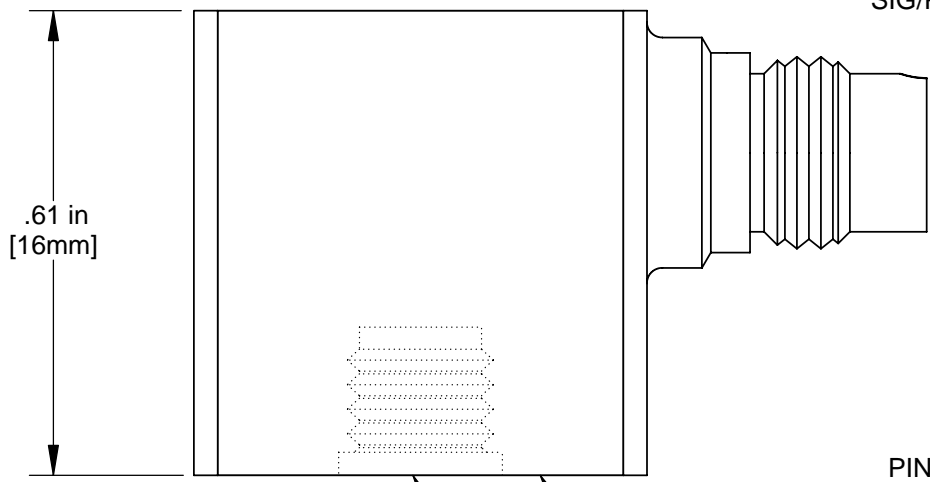

PIN 4 SIG/PWR AXIS 1 (X)

PIN 1 GND RETURN, COMMON

PIN 3 SIG/PWR AXIS 3 (Z)

3 (+Z) AXIS

PIN 2 SIG/PWR AXIS 2 (Y)

TAPPED HOLE 10-32 X .150 DEEP

MOUNTING SURFACE

5. MOUNTING SCREW (10-32 UNC-2B) MODEL 6200 ,PROVIDED

4. WEIGHT = 10 GRAMS

$\triangle 3$  XX = CABLE LENGTH IN FEET

2. + SIGNS INDICATE SENSITIVE AXIS AND DIRECTION OF INPUT ACCELERATION FOR POSITIVE GOING OUTPUT SIGNAL.

1. HOUSING MATERIAL TITANIUM 6AL-4V

EXCEPT AS OTHERWISE NOTED

ALL DIMENSIONS IN INCHES TOLERANCE: .XX =  $\pm .01$

<b>DYTRAN</b>		INSTRUMENTS, INC.		CHATSWORTH, CA	
SCALE	4:1	REV	-	DATE	-
DATE	9/3/2004	PART NO.	MODEL 3093M8		
DRAWN	P. Casucci	CHECKED	R.A.		
APPROVED		NEXT ASSEMBLY	USED ON	3093M8	
TITLE			DWG NO.		
OUTLINE / INSTALLATION DRAWING			127-3093M8		
MODEL 3093M8			SHEET 1 OF 1		

**SPECIFICATIONS**  
**MODEL 3093M8 TRIAXIAL ACCELEROMETER WITH TEDS**

<b>SPECIFICATIONS</b>	<b>VALUE</b>	<b>UNITS</b>
RANGE, F.S. (each axis, for $\pm 5$ volts out)	$\pm 50$	G
SENSITIVITY, +15 -10% [1]	100	mV/G
FREQUENCY RESPONSE, +/- 10%	2 to 5000	Hz
ELEMENT NATURAL FREQUENCY	>30	kHz
DISCHARGE TIME CONSTANT	0.5 to 1.5	SEC
EQUIVALENT ELECTRICAL NOISE	.0007	G, RMS
LINEARITY [2]	1	%F.S.
TRANSVERSE SENSITIVITY, MAX,	5	%
OUTPUT BIAS VOLTAGE	+11 to +13	VDC
OUTPUT IMPEDANCE, TYP.	100	OHMS
TEMPERATURE RANGE	-60 to +225	$^{\circ}$ F
TEDS OPERATIONAL TEMPERATURE	-60 to +185	$^{\circ}$ F
COEFFICIENT OF THERMAL SENSITIVITY	.03	%/ $^{\circ}$ F
MAXIMUM VIBRATION	+/- 100	G
MAXIMUM SHOCK	3000	G
SIZE (HEIGHT x WIDTH x DEPTH)	0.61 x .59 x .59	INCHES
WEIGHT	10.0	GRAMS
CONNECTOR	4-PIN [3]	
SUPPLY CURRENT RANGE, (each axis) [4]	2-to 20	mA
COMPLIANCE (SUPPLY) VOLTAGE RANGE (each axis)	+18 to +30	VDC
MATERIAL, HOUSING/CONNECTOR	6AL-4V	TITANIUM
ENVIRONMENTAL SEAL	HERMETIC	
MOUNTING [5]	10-32 UNC-2B	
GROUND ISOLATION	10, MIN.	MEGOHMS
IEPE SENSOR WITH TEDS FEATURE	PER IEEE 1451.4	

[1] Reference sensitivity measured at 100 Hz, 1 G RMS per ISA RP 37.2

[2] Linearity is % of specified full scale (or any lesser full-scale range), zero-based best-fit straight-line method.

[3] Connector mates with Dytran cable assy. Model 6811Axx. (xx = length in feet)

[4] Power only with Dytran LIVM power unit or other Dytran-compatible constant current type power unit. If power is applied without current limiting protection, the internal amplifier will be immediately destroyed.

[5] Case ground isolation is achieved by internal means.